

EDHCSD NEW PARKS COMPARISON

HERITAGE PARK

Opening: unofficial 2023
Permits: Incomplete/rejected
4.6 Acres
50 ft stadium & 12 court lights
5 unshielded parking lot lights
Playground *next* to homes
Restroom, drinking fountain
26 Spaces Parking Lot w/ 5 lights
Tennis Courts
Pickleball Courts
Bocce ball Courts
Class 1 AC Bike/walking trail

BLACKSTONE PARK

Grand Opening: June 17, 2023
Permits: Complete
13.6 Acres
2 shielded street lights
1 parking shielded lot light
Playground *away from* homes
Restroom, drinking fountain
9 Spaces Parking Lot w/ 1 light
Walking path
NO sports courts
4 Fitness “nodes” on path

New Parks: Located less than two miles apart

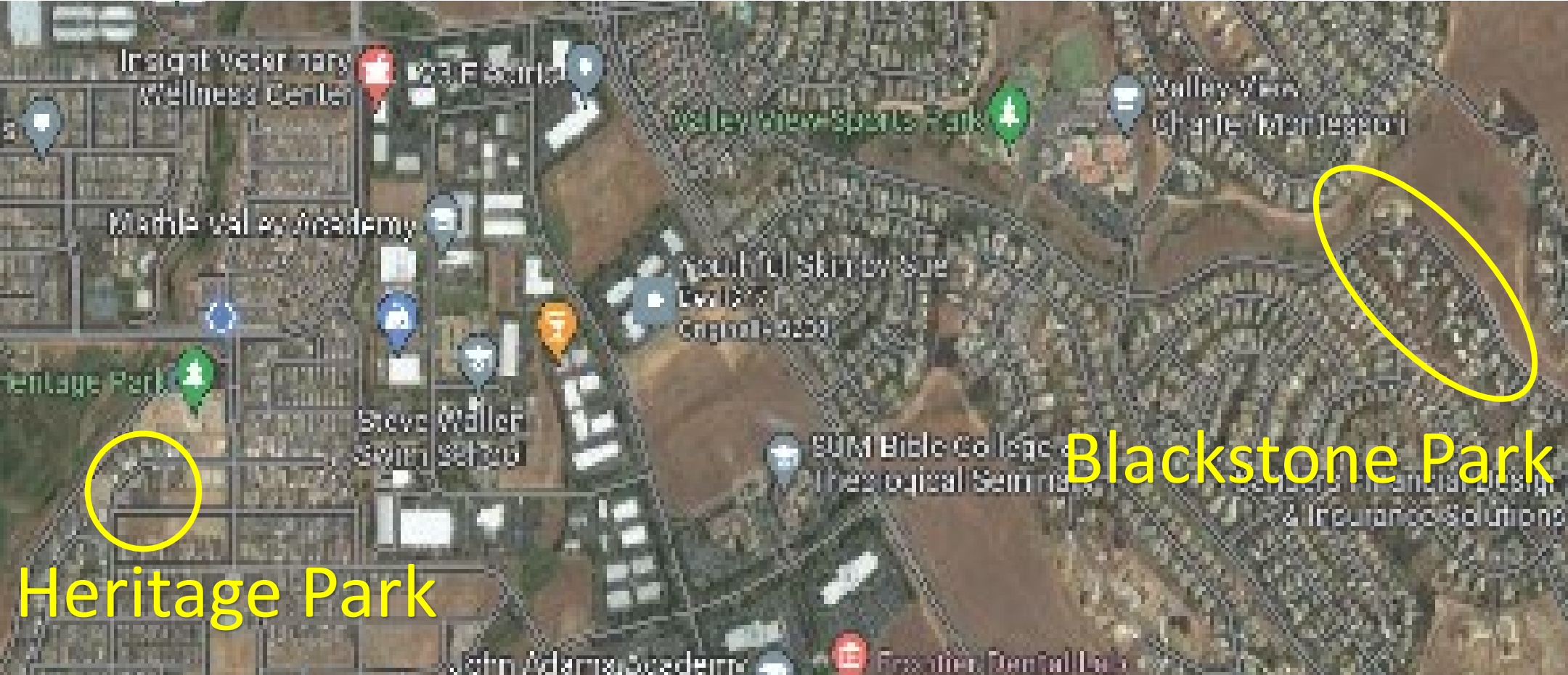

Parks Design and Amenities

Heritage Park: 4.65 acres

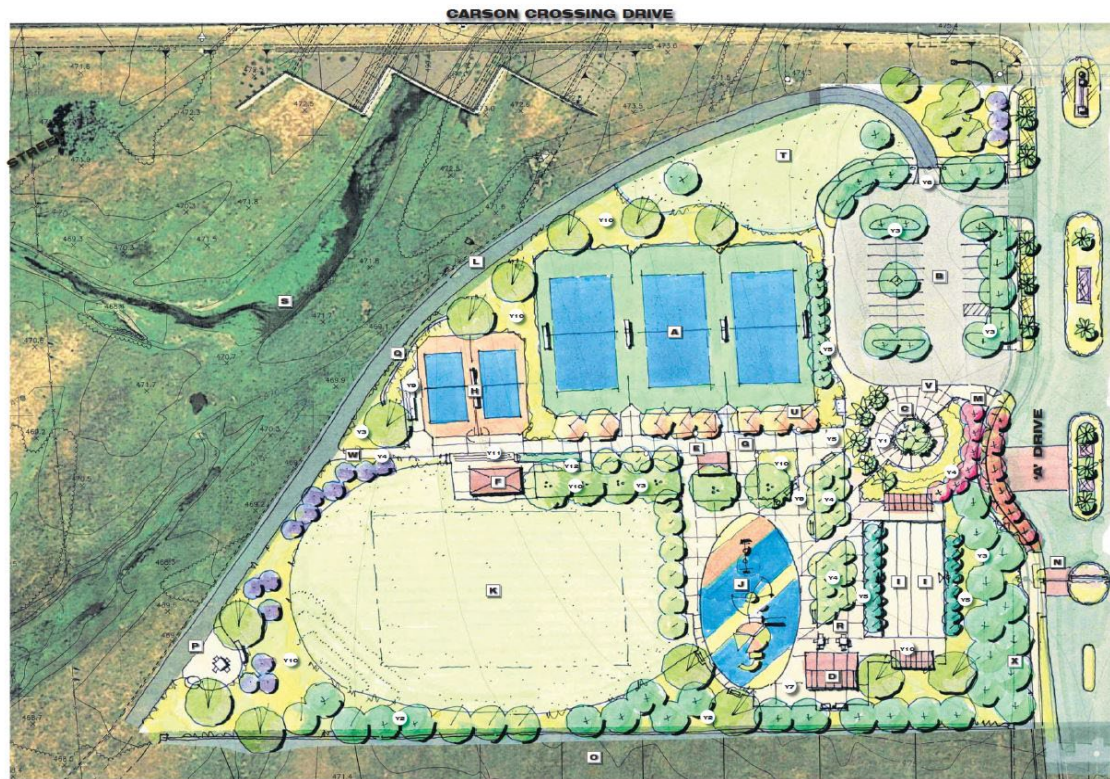

Blackstone Park – 13.6 acres



Proximity to Residences



HERITAGE PARK:
Within feet of residences on
raised ground above homes
Amenities tower above the
tops of home roof tops
No visual buffer provided

BLACKSTONE PARK: Amenities with large open space buffers located below visual sight to residences



LIGHTING: Above versus below home line of sight

HERITAGE: Lights farm with 50 ft stadium, 35 ft standards, unshielded 25 ft parking lot and 20 ft bocce ball court lights



BLACKSTONE: 15 ft standards with shielded lights ... one parking lot, two street



Additional Comparatives Items

- Heritage Park's tennis, pickleball, and bocce balls court already exist in the Heritage Village Community
- Blackstone residential community does not have the sports courts
- Amenities within Heritage Park are inconsistent with the Carson Creek Specific Plan resulting in litigation against EDH CSD
- Amenities with Blackstone Park appear consistent with the Valley View Specific Plan
- Heritage residents pay for 78.8% LLAD assessments, Blackstone Park assessment not yet defined

Questions for CSD Board and Management

- Did anyone every ask why all the sports courts are jammed into the small Heritage park instead of the 13.6 acre Blackstone park?
- Why did CSD ignore the requests from Blackstone residents for amenities located in the Heritage park?
- What is the impact of excessive lights for parks designed for dawn to dusk usage?
- Why are Heritage residents expected to pay for the maintenance, operations and repair of a park designed for remote users?
- Did any staff member ask any design questions for two parks only two miles apart?